

Aluminum-Alloy Maintenance Trolleys for the Super-Long Bridge*

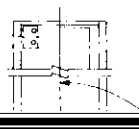

Synopsis:

The design of the aluminum-alloy-made maintenance trolleys, which was to be equipped to the Bannosu-Bridge as a part of the Koiima-Sakaide route linking Honshu and

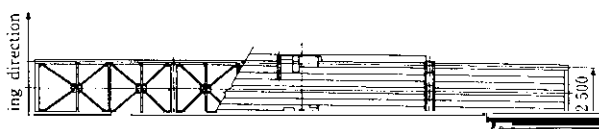

of these trolleys are given below.

Travelling: 2 to 10 m/min variable; 1.5 kW squirrel-cage motor (with brakes)

Slowing: 0.5 rpm; 1.5 kW squirrel cage motor (with

the following countermeasures were incorporated in the design of the maintenance trolleys:

(1) For bolts in the aluminum-alloy portion, stainless steel (AISI 316) was used as a rule, and where